

24" BANDSAW

Model 2415

Instruction Manual & Parts List

M-0460229



POWERMATIC

WMH TOOL GROUP

(800) 274-6848
www.powermatic.com

This manual has been prepared for the owner and operators of a Powermatic Model 2415 Bandsaw. Its purpose, aside from machine operation, is to promote safety through the use of accepted correct operating and maintenance procedures. Completely read the safety and maintenance instructions before operating or servicing the machine. To obtain maximum life and efficiency from your bandsaw, and to aid in using the machine safely, read this manual thoroughly and follow all instructions carefully.

Warranty & Service

The WMH Tool Group warrants every product it sells. If one of our tools needs service or repair, one of our Authorized Repair Stations located throughout the United States can give you quick service.

In most cases, any one of these WMH Tool Group Repair Stations can authorize warranty repair, assist you in obtaining parts, or perform routine maintenance and major repair on your JET, Powermatic, Performax, or Wilton tools.

For the name of an Authorized Repair Station in your area, please call 1-800-274-6848.

More Information

Remember, the WMH Tool Group is consistently adding new products to the line. For complete, up-to-date product information, check with your local WMH Tool Group distributor.

WMH Tool Group Warranty

The WMH Tool Group makes every effort to assure that its products meet high quality and durability standards and warrants to the original retail consumer/purchaser of our products that each product be free from defects in materials and workmanship as follow: 1 YEAR LIMITED WARRANTY ON ALL PRODUCTS UNLESS SPECIFIED OTHERWISE. This Warranty does not apply to defects due directly or indirectly to misuse, abuse, negligence or accidents, normal wear-and-tear, repair or alterations outside our facilities, or to a lack of maintenance.

THE WMH TOOL GROUP LIMITS ALL IMPLIED WARRANTIES TO THE PERIOD SPECIFIED ABOVE, FROM THE DATE THE PRODUCT WAS PURCHASED AT RETAIL. EXCEPT AS STATED HEREIN, ANY IMPLIED WARRANTIES OR MERCHANTABILITY AND FITNESS ARE EXCLUDED. SOME STATES DO NOT ALLOW LIMITATIONS ON HOW LONG THE IMPLIED WARRANTY LASTS, SO THE ABOVE LIMITATION MAY NOT APPLY TO YOU. THE WMH TOOL GROUP SHALL IN NO EVENT BE LIABLE FOR DEATH, INJURIES TO PERSONS OR PROPERTY, OR FOR INCIDENTAL, CONTINGENT, SPECIAL, OR CONSEQUENTIAL DAMAGES ARISING FROM THE USE OF OUR PRODUCTS. SOME STATES DO NOT ALLOW THE EXCLUSION OR LIMITATION OF INCIDENTAL OR CONSEQUENTIAL DAMAGES, SO THE ABOVE LIMITATION OR EXCLUSION MAY NOT APPLY TO YOU.

To take advantage of this warranty, the product or part must be returned for examination, postage prepaid, to an Authorized Repair Station designated by our office. Proof of purchase date and an explanation of the complaint must accompany the merchandise. If our inspection discloses a defect, we will either repair or replace the product, or refund the purchase price if we cannot readily and quickly provide a repair or replacement, if you are willing to accept a refund. We will return repaired product or replacement at WMH's expense, but if it is determined there is no defect, or that the defect resulted from causes not within the scope of WMH's warranty, then the user must bear the cost of storing and returning the product. This warranty gives you specific legal rights; you may also have other rights which vary from state to state.

The WMH Tool Group sells through distributors only. Members of the WMH Tool Group reserve the right to effect at any time, without prior notice, those alterations to parts, fittings, and accessory equipment which they may deem necessary for any reason whatsoever.

TABLE OF CONTENTS

Safety:	
General Rules	4
Specific Rules	5
Decals	7
Specifications	8
Receiving the Bandsaw	9
Installation	9
Electrical Connections	9
Assembly	9
Fence Assembly	9
Adjustments:	
Table Tilt	10
90 Degree Table Stop	10
Changing Blades	11
Adjusting Blade Tension	11
Adjusting Blade Tracking	11
Upper Blade Guide Assembly	12
Upper Blade Guides & Blade Support Bearing	12
Lower Blade Guides & Blade Support Bearing	12
Brake Pedal	13
Adjusting Belt Tension	13
Adjusting Belt Alignment	13
Trouble-shooting	14
Optional Accessories	15
Parts Lists & Exploded Views:	
Saw Body Assembly	16-17
Table Assembly	18-19
Upper Wheel Base Assembly	20-21
Lower Wheel Assembly	22-23
Guide Bracket Assembly	24-25
Electrical Schematics:	
Model 2415, 1 Phase	26
Model 2415, 3 Phase	27

SAFETY: General Rules

As with all machines, there is a certain amount of hazard involved with the use of this bandsaw. Use the machine with the respect and caution demanded where safety precautions are concerned. When normal safety precautions are overlooked or ignored, personal injury to the operator can result.

Know your tool. Read the owner's manual carefully. Learn the tools applications and limitations, as well as the specific potential hazards peculiar to it.

Keep guards in place and maintained in working order.

Ground all tools. If tool is equipped with three-prong plug, it should be plugged into a three-hole electrical receptacle. If an adapter is used to accommodate a two-prong receptacle, the adapter plug must be attached to a known ground. Never remove the third prong.

Remove adjusting keys and wrenches. Form habit of checking to see that keys and adjusting wrenches are removed from tool before turning it on.

Keep work area clean. Cluttered areas and benches invite accidents.

Avoid dangerous environment. Don't use power tools in damp or wet locations, or expose them to rain. Keep work area well lighted.

Keep children and visitors away. All children and visitors should be kept a safe distance from work area.

Make workshop childproof with padlocks, master switches, or by removing starter keys.

Don't force tool. It will do the job better and be safer at the rate for which it was designed.

Use right tool. Don't force tool or attachment to do a job it was not designed for.

Wear proper apparel. Do not wear loose clothing, gloves, neckties, or jewelry that can get caught in moving parts. Nonslip footwear is recommended. Wear protective hair covering to contain long hair

Use safety glasses. Always wear safety goggles that comply with ANSI Z87.1 (or in Canada CSA Z94-3-M88). Everyday eyeglasses have only impact resistant lenses - they are NOT safety glasses. Also use face or dust mask if cutting operation is dusty.

Secure work. Use clamps or a vise to hold work when practical. It's safer than using your hand and frees both hands to operate tool.

Don't overreach. Keep your proper footing and balance at all times.

Maintain tools in top condition. Keep tools sharp and clean for best and safest performance. Follow instructions for lubricating and changing accessories.

Disconnect tools before servicing and when changing accessories.

Use recommended accessories. Consult the owner's manual for recommended accessories. The use of improper accessories may cause hazards.

Avoid accidental starting. Make sure switch is in "OFF" position before plugging in cord.

Never stand on tool. Serious injury could occur if the tool is tipped or if the cutting tool is accidentally contacted.

Check damaged parts. Before further use of the tool, a guard or other part that is damaged should be carefully checked to ensure that it will operate properly and perform its intended function - check for alignment of moving parts, binding of moving parts, breakage of parts, mounting, and any other conditions that may affect its operation. A guard or other part that is damaged should be properly repaired or replaced.

Never leave tool unattended. Turn power off. Don't leave tool until it comes to a complete stop.

Drugs, alcohol, medication. Do not operate tool while under the influence of drugs, alcohol, or any medication.

Health hazards. Some dust created by power sanding, sawing, grinding, drilling and other construction activities contains chemicals known to cause cancer, birth defects or other reproductive harm. Some examples of these chemicals are:

- * Lead from lead-based paint.
- * Crystalline silica from bricks and cement and other masonry products.
- * Arsenic and chromium from chemically-treated lumber.

Your risk from these exposures varies, depending on how often you do this type of work. To reduce your exposure to these chemicals, work in a well-ventilated area, and work with approved safety equipment, such as those dust masks that are specifically designed to filter out microscopic particles.



SAFETY: Specific Rules

WHEN INSTALLING OR MOVING THE SAW:

Reduce the risk of injury from unexpected saw movement.

- Put the saw on a firm level surface where there is plenty of room to handle and properly support the workpiece.
- Support the saw so the table is level and the saw does not rock.
- Bolt the saw to the floor or work surface if it tends to slip, walk or slide during operations like cutting long, heavy boards.
- Turn saw off and unplug cord before moving saw.

Reduce the risk of injury from electrical shock.

- Make sure your fingers do not touch the plug's metal prongs when plugging in or unplugging the saw.

Reduce the risk of back injury.

- Get help when you need to move the saw. Always get help if you need to lift the saw.

BEFORE EACH USE:

Inspect your saw.

- To reduce risk of injury from accidental starting, turn the switch off, unplug the saw, and remove the switch key before changing the setup, removing covers, guards or blade.
- Check for alignment of moving parts, binding of moving parts, breakage of parts, saw stability, and any other conditions that may affect the way the saw works.
- If any part is missing, bent or broken in any way, or any electrical part does not work properly, turn the saw off and unplug the saw.
- Replace the damaged or missing parts before using the saw again.
- Maintain tools with care. Keep the saw clean for best and safest performance. Follow instructions for lubricating.
- Remove adjusting keys and wrenches. Form a habit of checking for and removing keys and adjusting wrenches from table top before turning it on.

REDUCE THE RISK OF INJURY FROM JAMS, SLIPS, THROWN PIECES OR BROKEN BLADES.

Inspect your blade.

- Choose the right blade size, style and cutting speed for the material and the type of cutting you plan to do.
- Make sure the blade teeth point downward, toward the table.
- Make sure the blade guides and thrust bearings are properly adjusted.
- Make sure the blade tension is properly adjusted.

- Make sure the bevel clamp is tight and no parts have excessive play.
- Always adjust the upper blade guide and blade guard to just clear the workpiece; this minimizes the risk of accidental blade contact, blade breakage, and provides maximum blade support.

Inspect your work area.

- Keep work area clean.
- Cluttered areas and benches invite accidents. Floor must not be slippery from wax or sawdust.
- To reduce the risk of burns or other fire damage, never use the saw near flammable liquids, vapors or gases.

Plan your work.

- Use the right tool. Don't force tool or attachment to do a job it was not intended to do.
- Use this band saw to cut only wood, wood like products and plastics. NEVER use this bandsaw to cut metals.
- Know your saw. Read and understand the owner's manual and labels affixed to the tool. Learn its application and limitations as well as the specific potential hazards peculiar to this tool.
- To reduce the risk of injury from accidental contact with moving parts, don't do layout, assembly, or set up work on the saw while any parts are moving.
- Reduce the risk of accidental starting. Make sure switch is "OFF" before plugging saw into a power outlet.

Inspect your workpiece.

- Make sure there are no nails or foreign objects in the part of the workpiece to be cut.

Use extra caution with large, very small or awkward workpieces.

- Use extra supports (tables, saw horses, blocks, etc.) for any workpiece large enough to tip when not held down to the table top.
- NEVER use another person as a substitute for a table extension, or as additional support for a workpiece that is longer or wider than the basic saw table, or to help feed, support or pull the workpiece.
- When cutting irregularly shaped workpieces, plan your work so it will not slip and pinch the blade. a piece of molding, for example, must lie flat or be held by a fixture or jig that will not let it twist, rock or slip while being cut.
- Properly support round material such as dowel rods, or tubing. They have a tendency to roll during a cut, causing the blade to "bite." To reduce the risk of this, always use a "V" block or clamp the work to the miter gauge.
- Cut only one workpiece at a time.
- Clear everything except the workpiece and related support devices off the table before turning on the saw.

Familiarize yourself with the following safety notices used in this manual:



CAUTION: (This means that if precautions are not heeded, it may result in minor or moderate injury and/or possible machine damage)



WARNING: (This means that if precautions are not heeded, it could result in serious injury or possibly even death).

SAFETY DECALS

Familiarize yourself with the location of all decals on your bandsaw.

WARNING

1. Read and understand instruction manual before operating bandsaw.
2. Always wear eye protection.
3. Do not wear gloves, neckties, jewelry or loose clothing. Tie back long hair.
4. Check blade rotation and make sure teeth point downward toward table.
5. Maintain proper adjustment of blade tracking and tension blade guides and back up bearings.
6. Adjust upper blade guard/guide to just clear work piece.
7. Close wheel guard covers before operating.
8. Hold work piece firmly against table.
9. Do not remove jammed work pieces until blade has come to a complete stop.
10. Keep hands out of the path of the saw blade.
11. Disconnect machine from power source before making any adjustments or performing any maintenance.
12. Do not operate while under the influence of drugs or alcohol.

DO NOT REMOVE OR OBSCURE THIS LABEL

SPECIFICATIONS - 2415 Bandsaw

Cutting Capacity	13-5/8" x 24-1/4"
Blade Length	180-1/2"
Minimum Blade Width	1/4"
Maximum Blade Width	1-1/2"
Table Size	24" x 28"
Table Tilt	45 degrees right, 10 degrees left
Table Height	37"
Wheel Diameter	24-1/2"
Blade Speed	2000 & 4000 FPM
Dust Chute	4"
Base Dimensions	24" x 38"
Motor (TEFC)	3 HP, 1 Ph, 230V; or 5 HP, 3 Ph, 230/460V (prewired 230V)

RECEIVING THE BAND SAW

Unpack the band saw and all parts from the crate. Check for damage and ensure all parts are intact. Any damage should be reported immediately to your distributor and shipping agent. Before assembling, read the manual thoroughly, familiarizing yourself with correct assembly and maintenance procedures and proper safety precautions.

Contents of shipping container:

- 1 Bandsaw with table
- 1 Miter Gauge
- 1 Fence & Rails Assembly

INSTALLATION

Move the saw to its permanent location, which should be dry, well lit and have enough room on all sides to handle long stock or make adjustments to the machine. Clean the protective coating off exposed metal parts with a good commercial solvent or kerosene and a soft cloth. **DO NOT** use acetone, gasoline or lacquer thinner, as these may damage painted surfaces.

ELECTRICAL CONNECTIONS

WARNING: All electrical connections must be made by a qualified electrician. Failure to comply may result in serious injury.

NOTE: Before making electrical connections, confirm that your power source matches the rating on the band saw motor plate.

The model 2415 single-phase model is 230V only. The three-phase model comes prewired at the factory for 230V. Changing the three-phase model from 230 to 460V requires the use of the 460V on/off switch assembly.

To change from 230V to 460V (three phase models only), proceed as follows:

1. Disconnect machine from power source.
2. Open motor cover door.
3. Remove cover from motor junction box.
4. Change wires in accordance with the diagram on the inside of the cover.
5. Replace cover and rear cabinet panel.
6. Replace magnetic on/off switch with the 460V assembly (available from Powermatic).

The on/off switch is thermally protected. If the saw motor is overloaded or a momentary interruption of electrical current is sensed, the saw will shut off. Allow a few minutes for the saw to cool down, then reset the on/off switch:

1. Open switch plate on opposite side from the on/off buttons by removing the four screws.
2. Push the "stop" button on the on/off switch.
3. Replace switch cover.

ASSEMBLY

FENCE ASSEMBLY

1. Attach the front rail (A), Figure 1, to the cast iron table with two 5/16" x 1-1/4" hex cap bolts, two 5/16" lock washers, and two 5/16" flat washers. Bolts should be placed horizontally in approximately the center of the slot. Hand tighten only.

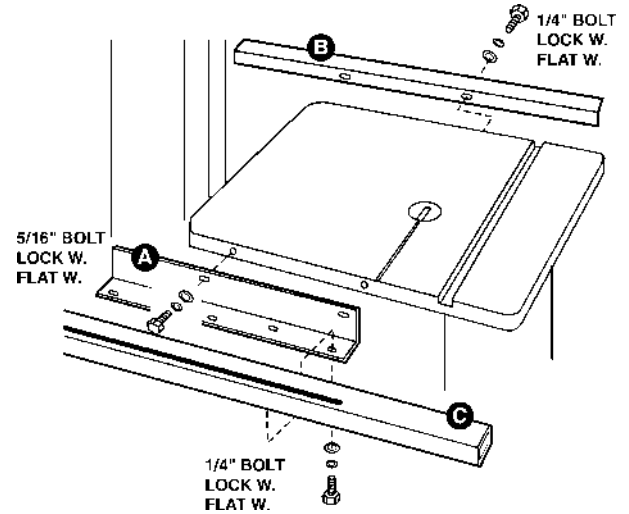

FIGURE 1

2. Attach the rear rail (B) to the table with two 1/4" x 5/8" hex cap bolts, two 1/4" lock washers, and two 1/4" flat washers. Hand tighten only.
3. Push the front and rear rails up as far as they will go.
4. Tighten the four hex cap bolts holding the front and rear rails to the table, with a wrench.
5. Attach the guide rail (C) to the front rail with five 1/4" x 5/8" hex cap bolts, five 1/4" lock washers, and five 1/4" flat washers. Hand tighten only at this time.

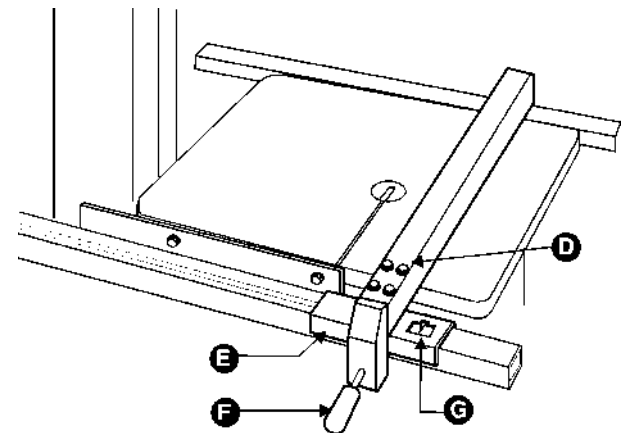

FIGURE 2

6. Attach the fence (D), Figure 2, to the fence body (E) with four 5/16" x 3/4" hex cap bolts, four 5/16" lock washers, and four 5/16" flat washers. Hand tighten only.

7. Place the fence assembly on the guide rail so that it aligns parallel to the miter slot along the entire length of the fence.

8. Lock the fence by pushing the lock handle (F) down.

9. Tighten the four hex cap bolts once the fence has been aligned to the miter slot. This alignment will again be checked once the guide rail has been tightened.

10. Move the fence assembly so that the pointer (G) on the fence body points to zero on the guide rail.

11. Move the guide rail and the fence, if necessary, so that the fence is flush to the blade. **Do not unlock the fence to perform this. Move the fence and guide rail together when establishing the zero point.**

12. Tighten the five hex cap bolts that hold the guide rail to the front rail.

13. Check the clearance between the table and the fence. The gap should be the same at the front of the table as it is at the rear. See Figure 3. If the gap width is different, adjust the foot at the rear of the fence until the gap width is the same.

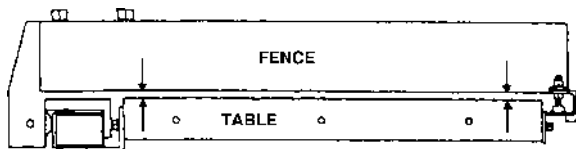

FIGURE 3

14. Check the adjustment of the hook at the back of the fence. It should be adjusted so that it overlaps the rear rail by approximately 1/8". See Figure 4.

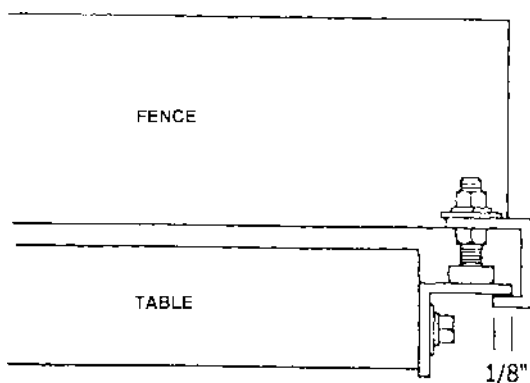

FIGURE 4

ADJUSTMENTS

TABLE TILT

1. Loosen the lock lever (A), Figure 5.
2. Tilt table up to 45 degrees to the right, or up to 10 degrees to the left.
3. Tighten the lock lever (A).

NOTE: The table stop bolt must be removed to tilt the table to the left.

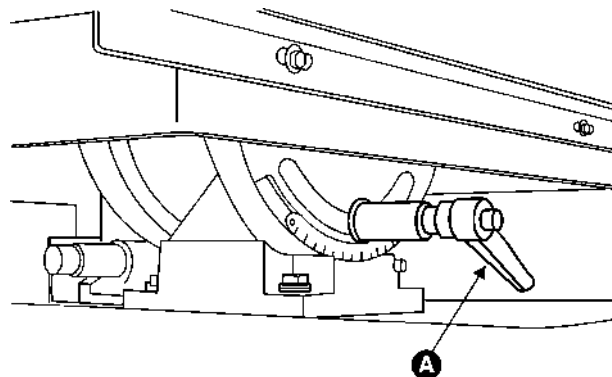

FIGURE 5

90 DEGREE TABLE STOP

1. Disconnect machine from power source.
2. Loosen lock lever (A), Figure 5, and tilt table left until it rests against table stop bolt.
3. Use a square placed on the table and against the blade to check that the table is 90 degrees to the blade.
4. If adjustment is necessary, loosen the lock lever (A).
5. Loosen lock nut (B), Figure 6, and turn table stop bolt (C) to raise or lower. Tighten the nut to hold table stop in place.
6. If necessary, adjust pointer to zero.

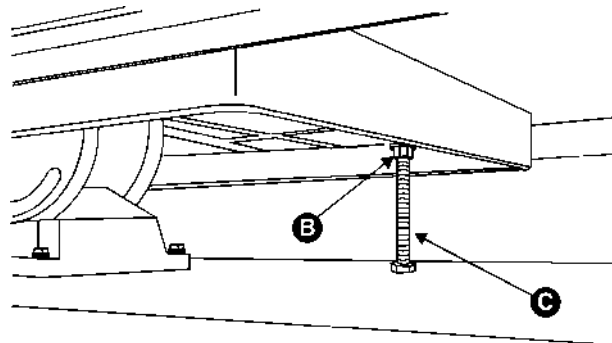

FIGURE 6

CHANGING BLADES

1. Disconnect machine from power source.
2. Loosen blade tension by turning blade tension hand wheel (A), Figure 7, counter-clockwise until it stops.

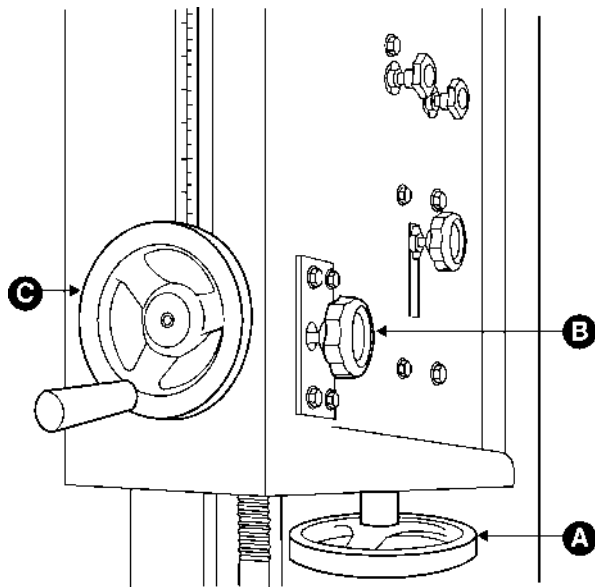

FIGURE 7

3. Remove the table insert.
4. Remove the set screw at the end of the slot on the table front.
5. Lower the upper blade guide assembly by loosening the lock knob (B) and turning the handwheel (C).
6. Open both wheel covers.
7. Carefully remove the blade from between upper and lower blade guides. Remove blade from upper and lower wheels.
8. Guide new blade through table slot. Place blade in upper and lower blade guides. NOTE: Make sure blade teeth point down toward table.
9. Place blade in the middle of the upper and lower wheels.
10. Replace table insert and set screw.
11. Tension and track blade before operating saw. Find instructions for tensioning and tracking the blade under "Adjusting Blade Tension" and "Adjusting Blade Tracking."

ADJUSTING BLADE TENSION

1. Disconnect machine from power source.
2. Turn blade tension handwheel (A-Figure 7) clockwise to tension blade and counter-clockwise to loosen the tension.

NOTE: A gauge at the top rear of the saw indicates the approximate tension according to the

width of the blade. Initially, set the blade tension to correspond to blade width.

As you become familiar with the saw, you may find it necessary to change the blade tension from the initial setting. Changes in blade width and the type of material being cut will have an effect on blade tension.

Keep in mind that too little or too much blade tension can cause blade breakage and/or poor cutting performance.

ADJUSTING BLADE TRACKING

Blade tracking has been factory-adjusted. However, if further adjustment is ever needed, proceed as follows:

NOTE: Make this adjustment with knob (D), Figure 8. Do not use knobs (F) or (G). These are used by the factory for wheel alignment and NOT for wheel tracking.

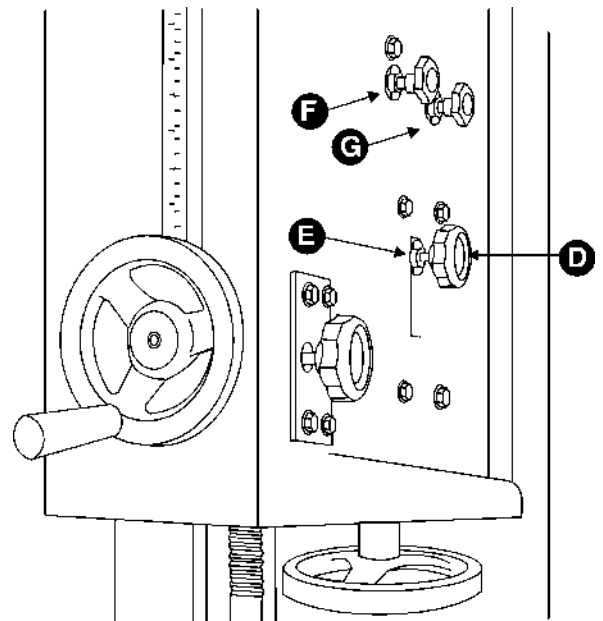

FIGURE 8

1. Disconnect machine from power source.
2. Blade must be properly tensioned before adjusting blade tracking. Make sure blade guides and guide bearings do not interfere with the blade.
3. Open top wheel cover. Rotate the wheel forward and observe the position of the blade on the wheel. It should be in the center.
4. If adjustment is necessary, loosen wing nut (E), and tighten knob (D) slightly to move blade toward rear of machine. Slightly loosening the knob (D) will cause the blade to track toward the front of the machine.
5. Once the blade is tracking in the center of the wheel, tighten wing nut (E).

UPPER BLADE GUIDE ASSEMBLY

1. Disconnect machine from power source.
2. Loosen lock knob (B), Figure 7, and raise or lower upper blade guide assembly by turning the handwheel (C).
3. Position the blade guide assembly just above the material to be cut.
4. Tighten lock knob (B).

UPPER BLADE GUIDES & BLADE SUPPORT BEARING

To adjust the bearing guides for proper blade control, proceed as follows (Figures 9 and 10).

1. Disconnect machine from power source.
2. Blade must already be tensioned and tracking properly.
3. Loosen the locking handle (A).
4. Adjust the guide bracket (B) with knob (G) so that the front of the guide wheels (C) are just behind the gullet (curved area at the base of the tooth) of the blade teeth.
5. Tighten the locking handle (A).
6. Loosen set screw (D) on guide wheel assemblies.
7. Adjust both guide wheels, with their respective knobs, to rest lightly against the blade. (NOTE: The rear guide wheel (H) rotates on an eccentric shaft). Do not force the guide wheel against the side of the blade.
8. Tighten set screw (D).
9. Loosen nut (E).
10. Adjust the front bearing with knob (F) until the space between the bearing and blade is between .003" - .005".
11. Tighten nut (E).

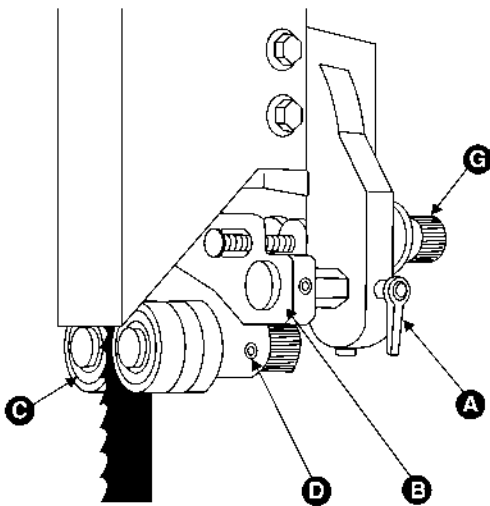

FIGURE 9

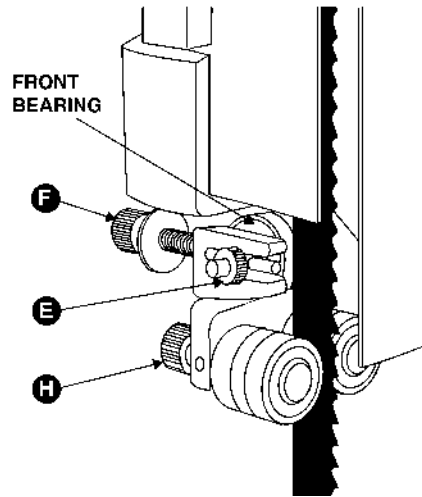

FIGURE 10

LOWER BLADE GUIDES & BLADE SUPPORT BEARING

1. Disconnect machine from power source.
2. Blade must already be tensioned and tracking properly.
3. Loosen two hex cap bolts (A), Figure 11.
4. Adjust the guide bracket (B) so that the front of the guide wheels are just behind the gullet (curved area at the base of the tooth) of the blade teeth.
5. Tighten two hex cap bolts (A).
6. Loosen lock nuts (C) on both guide wheel assemblies.
7. Adjust both guide wheels to rest lightly against the blade. Do not force the guide wheel against the side of the blade.
8. Tighten both lock nuts (C).
9. Loosen thumb screw (D).
10. Adjust the bearing bracket until the space between the bearing and the blade is between .003" - .005".
11. Tighten thumb screw (D).

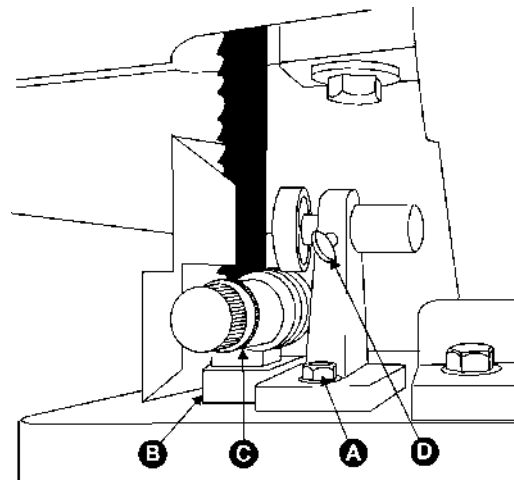

FIGURE 11

NOTE: The bearing holder on the shaft is eccentric. Blade support bearing should be adjusted so that the back edge of the blade overlaps the front face of the ball bearing approximately 1/8".

BRAKE PEDAL

To stop the saw, depress the brake pedal, Figure 12, while the saw is running. Re-start the saw by pressing the "on" switch.

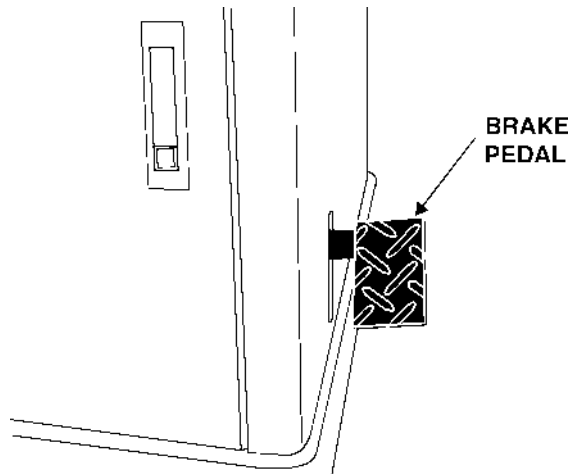

FIGURE 12

ADJUSTING BELT TENSION

The drive belt comes adjusted from the factory. However, should further adjustment be needed:

1. Disconnect machine from power source.
2. Open the motor cover door.
3. Loosen the four hex nuts (A), Figure 13, and loosen the nut on the tension adjustment screw (B).
4. Turn the adjustment screw (B) to push down the motor plate and increase tension.
5. When satisfied, tighten nut on adjustment screw (B) and the four hex nuts (A).

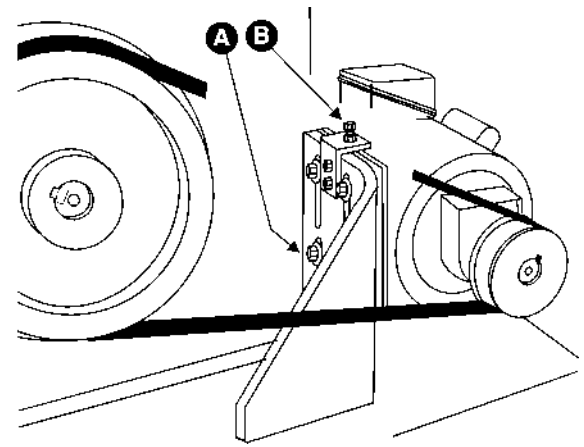

FIGURE 13

ADJUSTING BELT ALIGNMENT

If the drive belt is not aligned properly, adjust the set screw (C) on the motor plate in or out as necessary. See Figure 14.

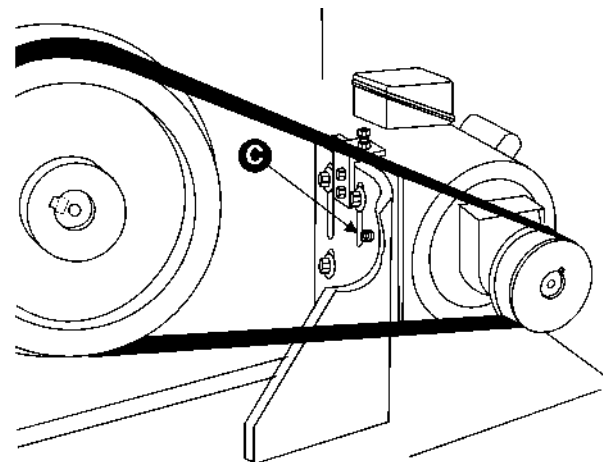

FIGURE 14

Trouble-Shooting for 2415 Bandsaw

PROBLEM	POSSIBLE CAUSE	SOLUTION
Table tilt does not hold position load.	<ol style="list-style-type: none"> 1. Tilt lock is not tightened. 2. Tilt lock mechanism is broken or worn. 	<ol style="list-style-type: none"> 1. Tighten tilt lock. 2. Replace.
Table will not tilt.	<ol style="list-style-type: none"> 1. Trunnion is not lubricated. 2. Trunnion is jammed. 	<ol style="list-style-type: none"> 1. Lubricate. 2. Disassemble and replace jammed parts.
Table vibration (while sawing)	<ol style="list-style-type: none"> 1. Incorrect band speed 2. Incorrect choice of saw band pitch. 3. Worn or improperly adjusted saw guide inserts. 4. Worn saw guide back-up bearings. 	<ol style="list-style-type: none"> 1. Check speed and feed chart and correct speed for material. 2. Check speed and feed chart and change to correct blade. 3. Adjust or replace inserts. 4. Replace backup bearings.
Surface finish on workpiece rough.	<ol style="list-style-type: none"> 1. Saw guide inserts are worn. 2. Saw band speed is too low. 3. Saw band pitch is too coarse. 	<ol style="list-style-type: none"> 1. Replace inserts. 2. Increase speed. 3. Change to finer pitch blade.
Saw band cutting inaccurately.	<ol style="list-style-type: none"> 1. Worn blade teeth. 2. Incorrect saw band or insert alignment. 3. Post not square to table. 4. Incorrect band speed used. 5. Incorrect feed force used. 6. Saw guide on upper post not located close enough to workpiece. 7. Incorrect choice of saw band. 8. Incorrect saw band tension. 	<ol style="list-style-type: none"> 1. Replace blade. 2. Realign saw or inserts. 3. Square post to table. 4. Change to correct speed. 5. Reduce feed force. 6. Relocate post as close as possible to top of workpiece. 7. Change to correct band. 8. Readjust tension.

OPTIONAL ACCESSORIES (2415 Bandsaw)

6295057	Blade, 1/4 x .025 x 6 skip.
6295058	Blade, 3/8 x .025 x 4 skip.
6295059	Blade, 1/2 x .025 x 3 hook.
6295060	Blade, 3/4 x .032 x 3 hook.
6295061	Blade, 1 x .035 x 2 hook.
6295062	Blade, 1-1/4 x .035 x 1.3 hook.

PARTS LIST: Saw Body Assembly (2415 Bandsaw)

No.	Part No.	Description	No.	Part No.	Description
1	6294800	Body	18	6295130	Hex Socket Cap Screw, M6 x 12
2	6295114	Magnetic Switch, 1Ph, 230V	19	6295131	Power Cord, 1 Ph
	6295330	Magnetic Switch, 3Ph, 230V		6294805	Power Cord, 3 Ph
	6295136	Magnetic Switch, 3Ph, 460V	20	6294806	Blade Wheel
3	6295115	Switch Plate, 230V	21	6294807	Tire
	6295887	Switch Plate, 460V	22	6295134	Hex Nut, 3/4-16 (L.H.)
4	6295116	Washer, 3/16	23	6295135	Washer, 3/4"
5	6295117	Lock Washer, 3/16	24	6295061	Blade, 1" x .026 x 3 hook
6	6295118	Hex Nut, 3/16-24	25	6295137	Door Latch
7	6295119	Screw, 3/16 x 3/8	26	6295138	Door Catch
8	6295120	Screw, 3/16 x 3/4	27	6295139	Screw, M4 x 4
9	6295121	Dust Chute	28	6294808	Lower Front Door
10	6295122	Washer, 5/16	29	6294809	Upper Front Door
11	6295123	Hex Cap Bolt, 5/16 x 1	30	6295142	Stop Button
12	6295124	Hex Nut, 3/16-24NC	31	6295143	Start Button
13	6295125	Hex Nut, 5/16	32	6294810	Scale
14	6295126	Brush	33	6294811	I.D. Label
15	6295127	Screw, 3/16 x 1-1/2	34	6295146	Warning Label
16	6294804	Lower Back Door	35	6295147	Name Plate
17	6295129	Washer, 1/4	36	6295888	Transformer, 230V

Saw Body Assembly (2415 Bandsaw)

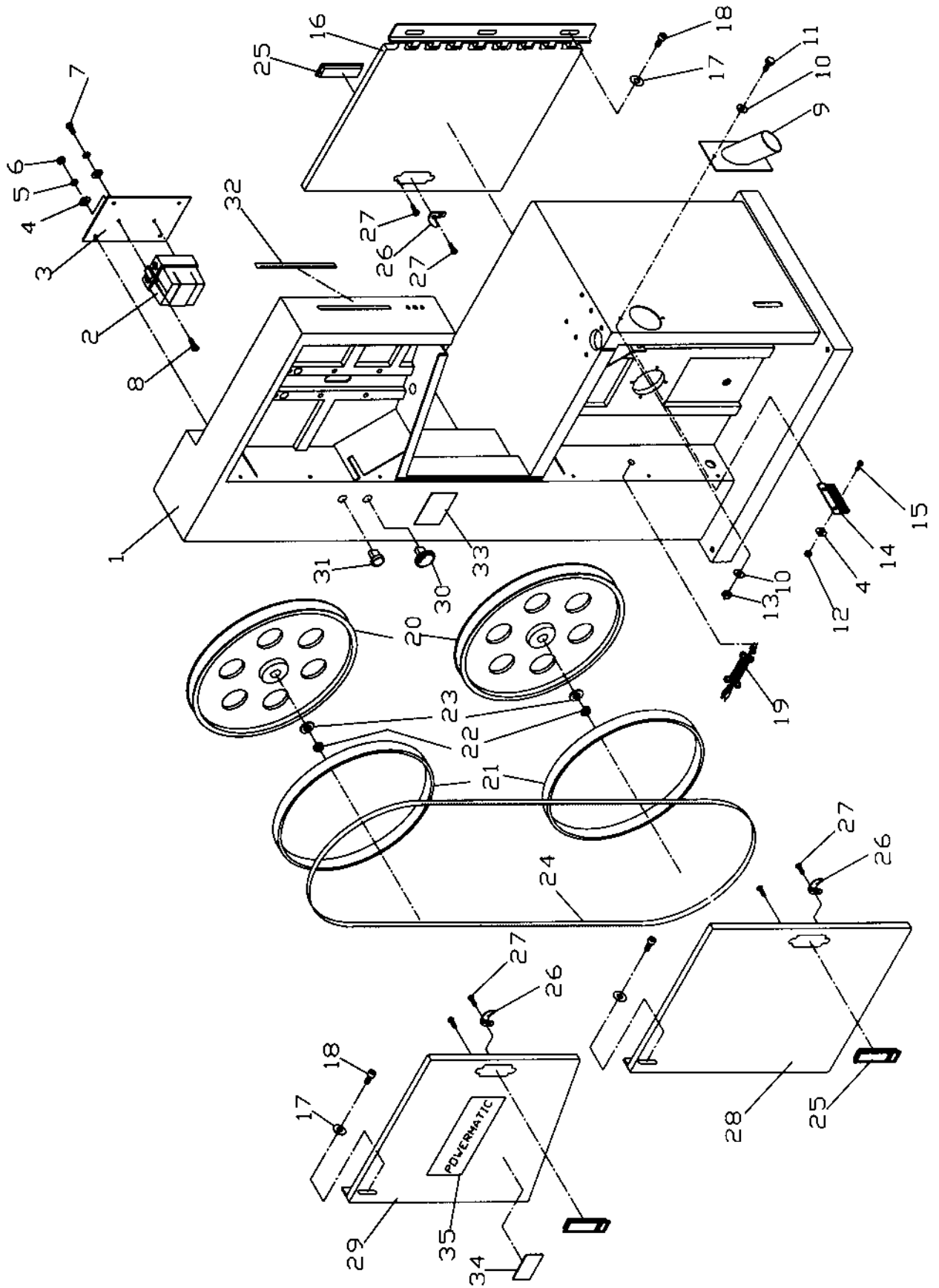

PARTS LIST: Table Assembly (2415 Bandsaw)

No.	Part No.	Description	No.	Part No.	Description
1	6295148	Carriage Bolt, 1/2 x 6	28	6295175	Washer, 1/4
2	6295149	Trunnion	29	6294837	Rear Rail
3	6295150	Table Bracket	30	6295177	Table Insert
4	6295151	Washer, 3/8	31	6295178	Spring Pin, 3 x 10
5	6295152	Lock Washer, 3/8	32	6295179	Hex Nut, 1/4
6	6295153	Hex Cap Bolt, 3/8 x 1-1/4	33	6295180	Rear Hook
7	6295154	Name Plate	34	6295181	Sliding Pad
8	6295155	Pointer	35	6295182	Hex Nut, 3/8
9	6295156	Lock Washer, 3/16	36	6295183	Hex Cap Bolt, 3/8 x 4
10	6295157	Screw, M5 x 12	37	6294838	Scale
11	6295158	Locking Handle	38	6294839	Guide Rail
12	6295159	Washer, 1/2	39	6294840	Fence
13	6295160	Angle Scale	40	6295187	Hex Cap Bolt, 5/16 x 3/4
	6295328	Mitre Gauge Assembly (Items 14 thru 24)	41	6295188	Lock Washer, 5/16
14	6295161	Pin	42	6295189	Flat Washer, 5/16
15	6295162	Flat Head Screw, 1/4	43	6295190	Screw, 3/16 x 1/4
16	6295163	Guide Disc	44	6295192	Star Washer, 3/16
17	6295164	Screw, M5 x 20	45	6295193	Pointer
18	6295165	Nut, M5	46	6295194	Fence Body
19	6295166	Knob	47	6295195	Knob
20	6295167	Mitre Gauge Body	48	6295196	Lock Handle
21	6295168	Pin	49	6295197	Lock Plate
22	6295169	Pointer	50	6295198	Pad
23	6295170	Set Screw, M4 x 4	51	6295199	Pin
24	6295171	Stop Block	52	6295200	Pin
25	6294836	Work Table	53	6295201	Bushing
26	6295173	Hex Cap Bolt, 1/4 x 5/8	54	6295202	Hex Cap Bolt, 5/16 x 1-1/4
	6294842	Fence Assembly (Items 7, 27, 28, 32, 33, 34, 39 thru 52)	55	6295203	Washer, 5/16
27	6295174	Lock Washer, 1/4	56	6295204	Set Screw, 5/16 x 5/8
			57	6295205	Set Screw, 5/16 x 3/8
			58	6294841	Front Rail

Table Assembly (2415 Bandsaw)

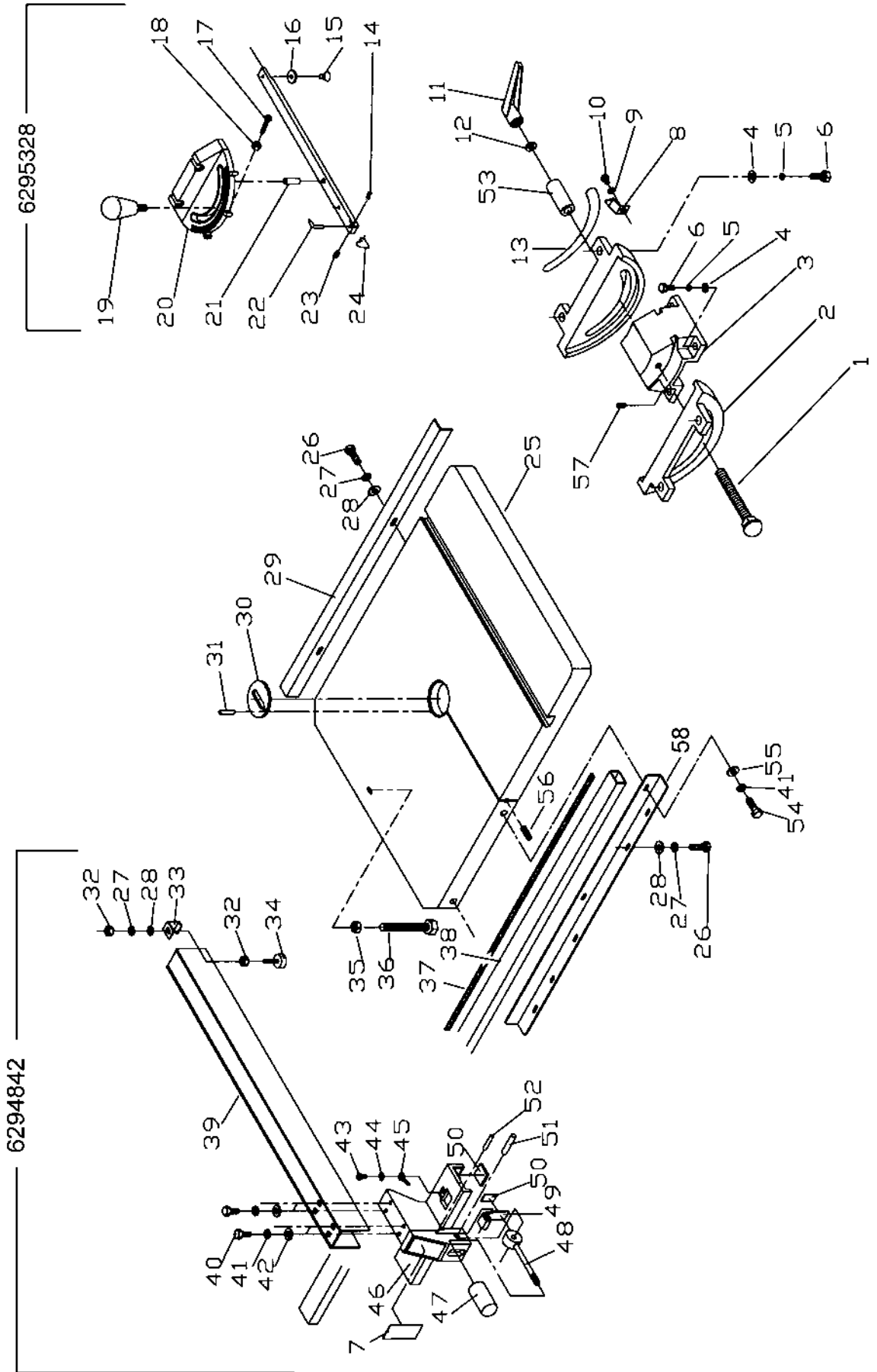

PARTS LIST: Upper Wheel Base Assembly (2415 Bandsaw)

No.	Part No.	Description	No.	Part No.	Description
1	6295889	Upper Wheel Shaft	17	6294813	Spring
2	6295207	Key, 7mm x 7mm x 25mm	18	6294814	Guide Bar
3	6295208	Ball Bearing, 6205	19	6295224	Screw, 3/16 x 5/8
4	6295209	Washer, 3/8	20	6294815	Bracket
5	6295210	Upper Wheel Bearing Bracket	21	6295226	Pointer
6	6295890	Lock Nut, 3/4-16 UNF	22	6295117	Lock Washer, 3/16
7	6295212	Set Screw, 5/16 x 1/2	23	6294816	Upper Wheel Bracket Base
8	6295213	C-Ring S-20	24	6295228	Bracket Shaft
9	6295214	Lever Shaft	25	6295229	Handwheel
10	6295215	Upper Adjustment Bracket	26	6295230	Lock Washer, 5/16
11	6295891	Upper Wheel Guide Bracket	27	6295231	Wing Nut, 5/16
12	6295217	Adjustment Bracket	28	6295232	Lock Knob
13	6295218	Wing Nut	29	6295233	Washer, 3/8
14	6295219	Lock Knob	30	6295234	Hex Cap Bolt, 3/8 x 1-3/4
15	6294812	Adjustment Screw	31	6295235	Work Lamp, 230V
16	6295221	Elevator Bracket	32	6294818	Scale (blade tension)

PARTS LIST: Lower Wheel Base Assembly (2415 Bandsaw)

No.	Part No.	Description	No.	Part No.	Description
1	6295237	Hex Socket Cap Screw, 1/4 x 1	27	6295257	Hex Cap Bolt, 5/16 x 1-1/2
2	6295129	Washer, 1/4	28	6295258	Core
3	6294819	Brake Pedal	29	6295259	Core Piece
4	6295239	Brake Locking Bracket	30	6295260	Fan Cover
5	6295240	Hex Nut, 1/4	31	6295261	Hose Connector
6	6295241	Spring	32	6295262	Air Input Valve
7	6295242	Brake Switch	33	6295263	Hex Socket Cap Screw, 1/4 x 1
8	6295182	Hex Nut, 3/8	34	6294825	Motor Pulley
9	6295243	Brake Wheel	35	6294826	V-Belt
10	6294820	Brake Belt	36	6294827	Hose
11	6294821	Brake Band	37	6295267	Set Screw, 5/16 x 3/8
12	6295246	Hex Cap Bolt, 1/4 x 3/4	38	6295268	Key, 7mm x 7mm x40mm
13	6295247	Key, 7 x 7 x 25	39	6295269	Motor Cord, 1 Ph
14	6295248	Shaft		6294828	Motor Cord, 3 Ph
15	6295249	Ball Bearing 6206	40	6294829	Motor Nameplate
16	6295250	Bearing Base	41	6295271	Hex Cap Bolt, 3/8 x 2-1/2
17	6295251	Adjusting Screw	42	6295272	Plate
18	6295152	Lock Washer, 3/8	43	6295273	Screw, M4 x 30
19	6295252	Hex Cap Bolt, 3/8 x 2	44	6295274	Hex Nut, M4
20	6295253	Hex Nut, M28	45	6294830	Motor Plate
21	6294822	Spindle Pulley	46	6294831	Set Screw, 5/16 x 1/2
22	6295255	Set Screw, 1/4 x 3/8	47	6294832	Belt Tension Bracket
23	6295189	Washer, 5/16	48	6294833	Hex Head Bolt, 5/16-18 x 5/8
24	6295188	Lock Washer, 5/16	49	6294834	Hex Head Bolt, 5/16-18 x 2.0
25	6295125	Hex Nut, 5/16			
26	6294823	Motor, 3 HP, 1 Ph			
	6294824	Motor, 5 HP, 3 Ph			

Lower Wheel Base Assembly (2415 Bandsaw)

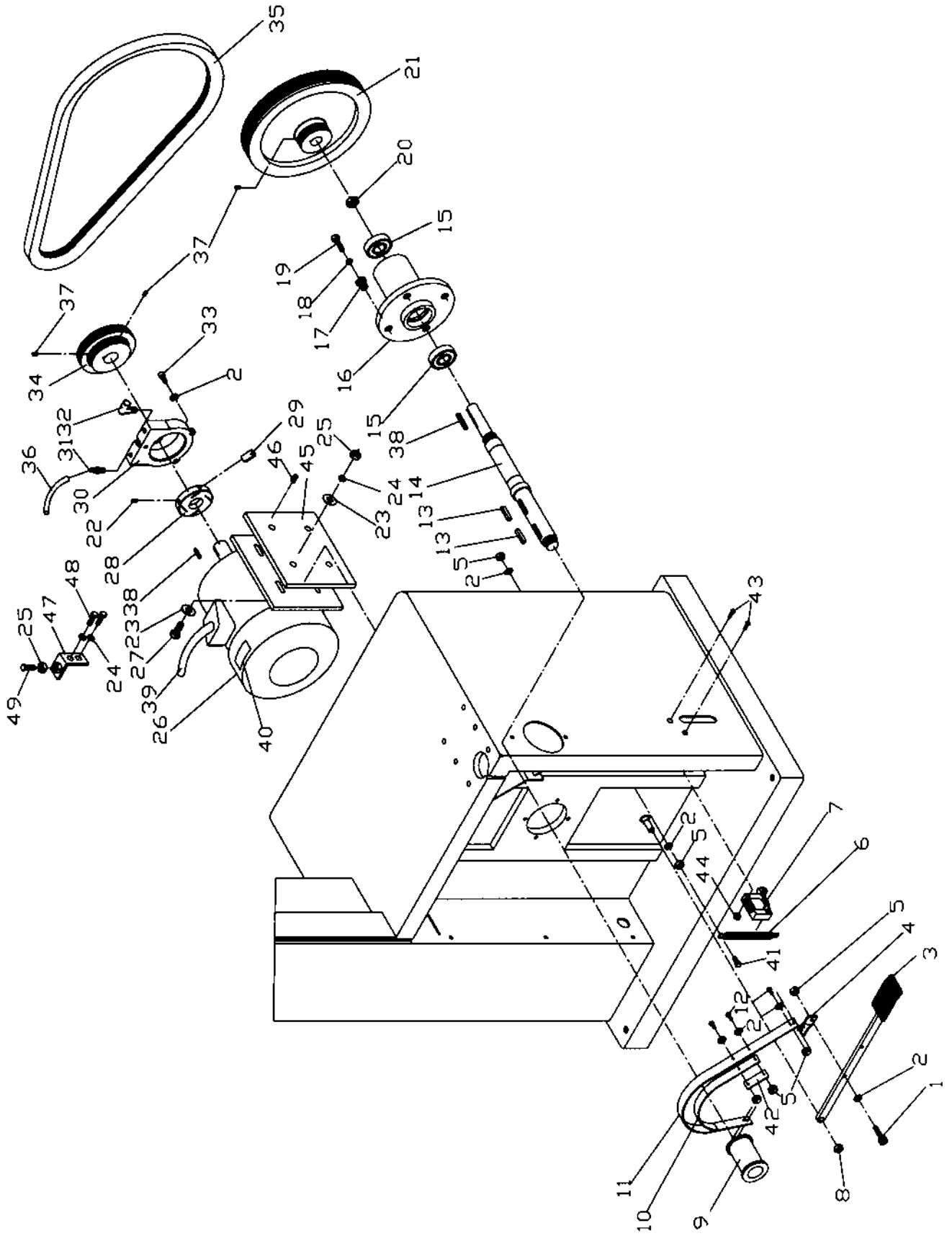

PARTS LIST: Guide Bracket Assembly (2415 Bandsaw)

No.	Part No.	Description	NO.	PART NO.	DESCRIPTION
1	6295275	Guide Bar Case Bracket	32	6295302	Support Bearing Shaft
2	6295276	Cover	33	6295303	Spacer
3	6295187	Hex Cap Bolt, 5/16 x 3/4	34	6295304	C-Ring, S-15
4	6295277	Hex Cap Bolt, 1/4 x 1/2	35	6295305	Ball Bearing 6202
5	6295278	Pointer	36	6295306	Shaft
6	6294835	Guide Bar	37	6295307	Knob, 3/8 x 2
7	6295280	Worm	38	6295123	Hex Cap Bolt, 5/16 x 1
8	6295281	Miniature Ball Bearing, 609	39	6295188	Lock Washer, 5/16
9	6295282	C-Ring, S-12	40	6295308	Ball Bushing
10	6295283	Gear	41	6295309	Bracket
11	6295284	Hex Socket Cap Screw 5/16 x 1-1/2	42	6295310	Hex Socket Cap Screw, 5/16 x 3/4
12	6295285	Gear Base	43	6295311	Plastic Washer
13	6295286	Set Block	44	6295312	Handwheel
14	6295287	Wing Screw, 1/4 x 1/4	45	6295313	Handle
15	6295288	Inner Blade Guard	46	6295314	Guide Wheel Assembly
16	6295289	Blade Guard	47	6295315	Blade Support Shaft w/ Bearing
17	6295290	Hex Cap Bolt, 1/4 x 5/8	48	6295316	Lower Guide Bracket
18	6295174	Lock Washer, 1/4	49	6295317	Hex Cap Bolt, 1/4 x 1
19	6295175	Washer, 1/4	50	6295318	Bracket
20	6295291	Guide Bar Bracket	51	6295122	Washer, 5/16
21	6295292	Set Screw, 5/16 x 2	52	6295319	Hex Socket Cap Screw, 1/4 x 1/2
22	6295293	Locking Handle, 1/4 x 3/4	53	6295320	Lower Blade Guard
23	6295170	Set Screw, M4 x 4	54	6295321	Locking Nut
24	6295294	Knob	55	6295322	C-Ring, E-5
25	6295295	Set Screw, 1/4 x 1/4	56	6295323	Air Nozzle
26	6295296	Lever Shaft	57	6295324	Hose Clamp
27	6295297	Hand Nut	58	6295119	Screw, 3/16 x 3/8
28	6295298	Bolt	59	6295325	Bracket
29	6295299	Support Bearing Bracket (L)	60	6295326	Nut, 3/16
30	6295300	Adjustment Bolt	61	6295116	Washer, 3/16
31	6295301	Hex Socket Cap Screw, 1/4 x 3/4	62	6295327	Support Bearing Shaft (R)

Guide Bracket Assembly (2415 Bandsaw)

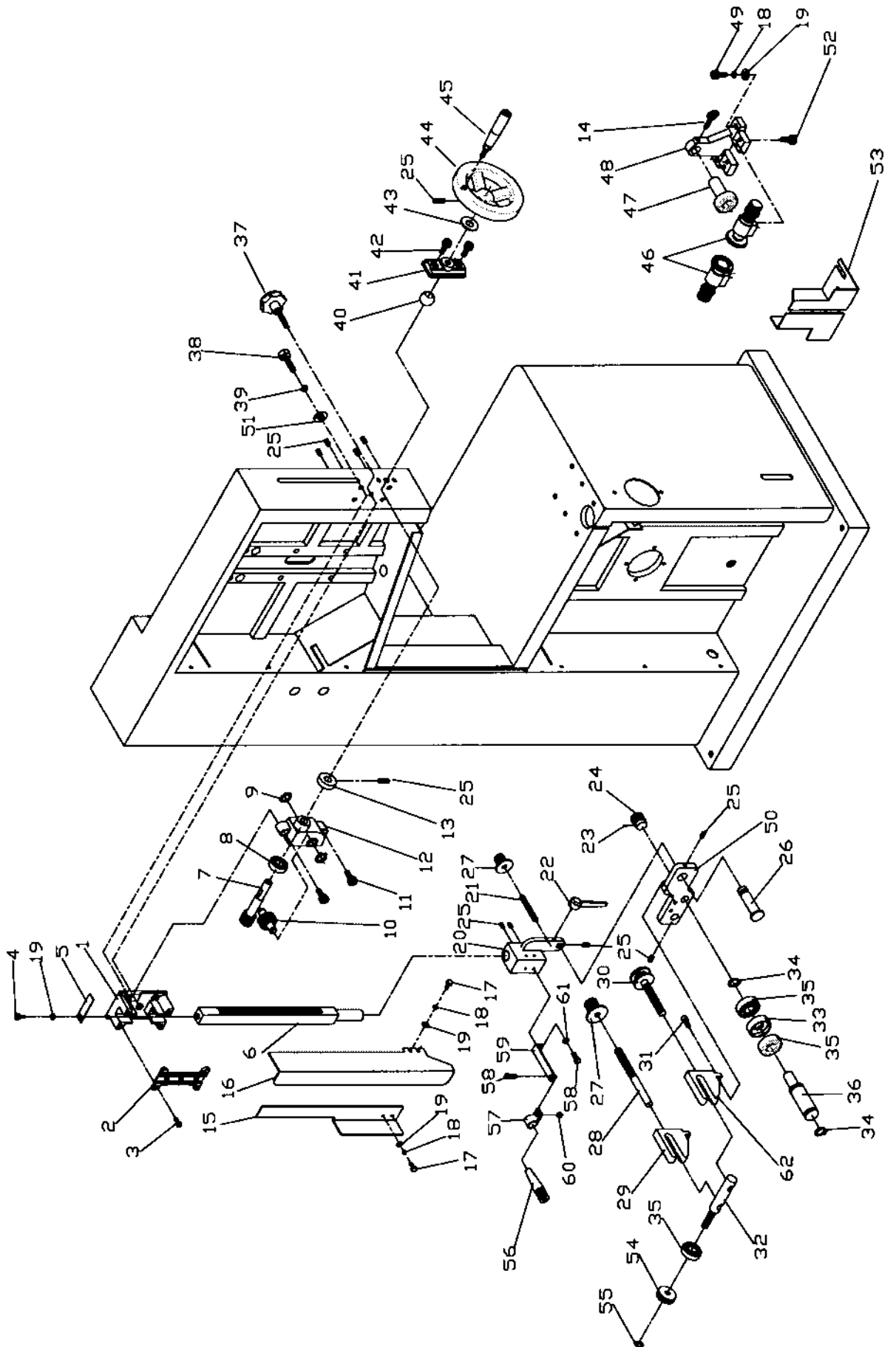

ELECTRICAL: Model 2415 Bandsaw

230V, 1 Phase

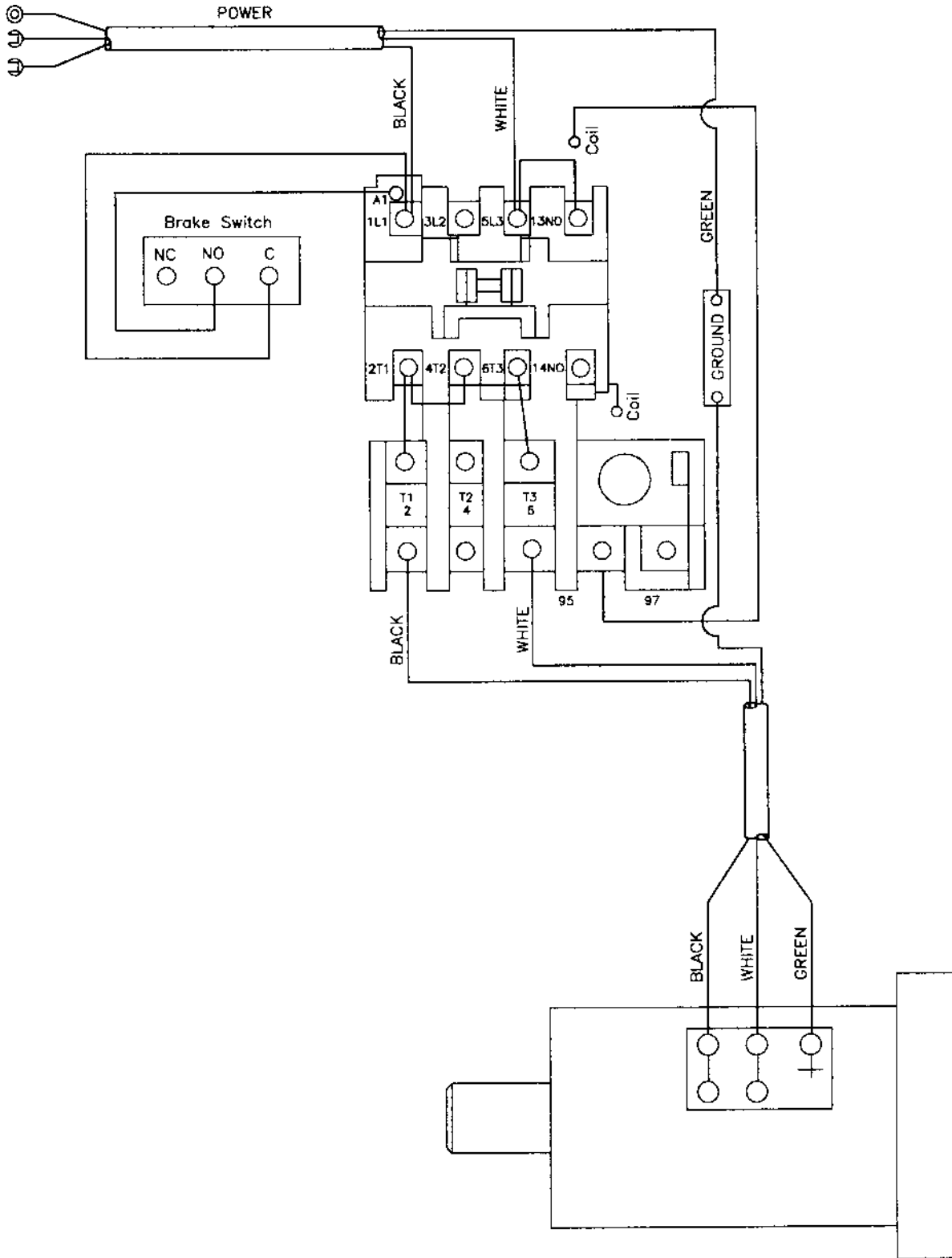

ELECTRICAL: Model 2415 Bandsaw

230/460V, 3 Phase

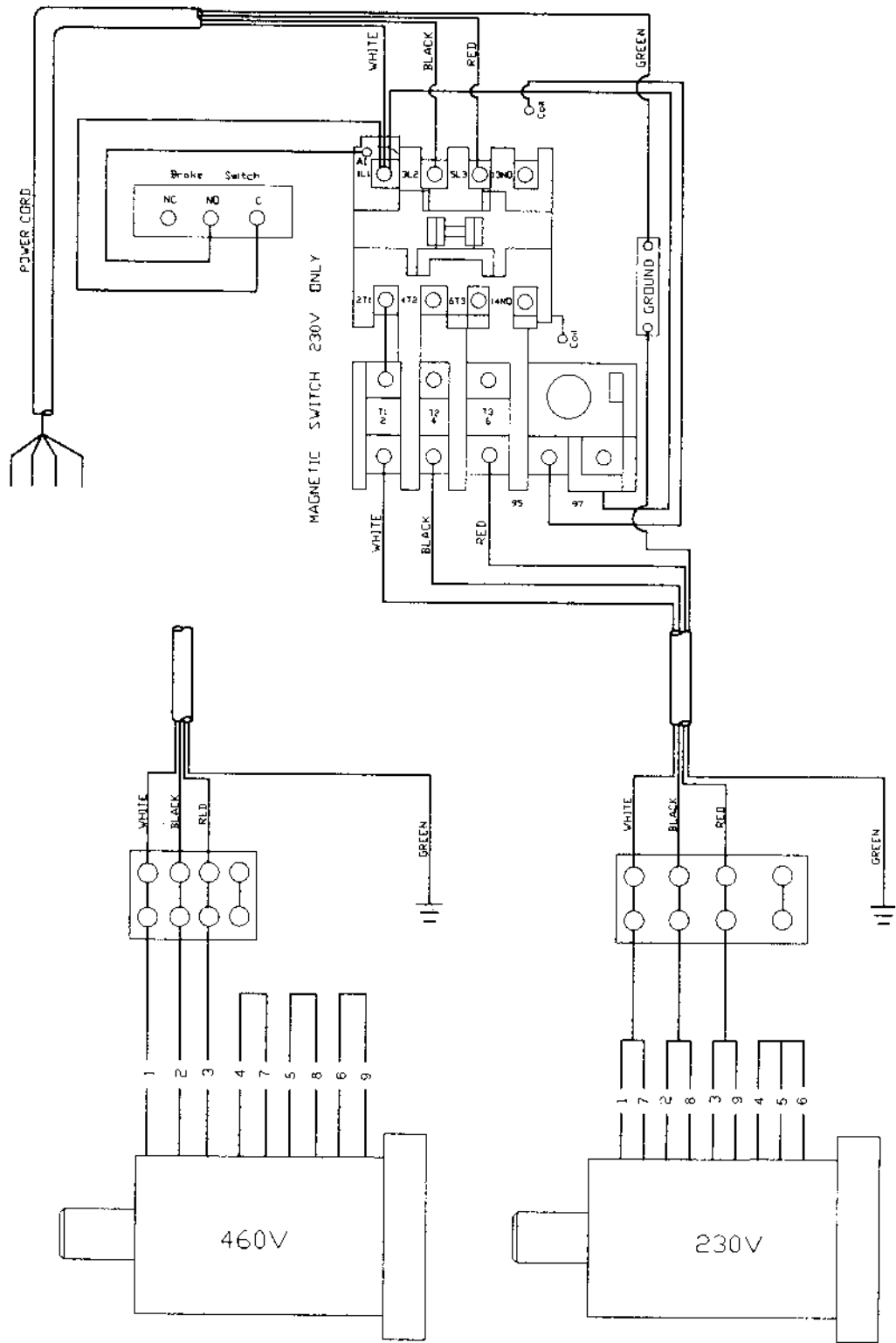

To order parts or reach our service department, please call our toll-free number between 8:00 a.m. and 4:30 p.m. (CST), Monday through Friday. Having the Model Number and Serial Number of your machine available when you call will allow us to serve you quickly and accurately. Locating the EDP number of the part(s) required from your parts manual will also expedite your order.

Phone No.: (800) 274-6848

Fax No. (800) 274-6840

If you are calling from Canada, please call 800-238-4746

E-mail: powermatic@powermatic.com

Website: www.powermatic.com

POWERMATIC

WMH TOOL GROUP

P.O. Box 1349
Auburn, WA 98071-1349
Phone: (800) 248-0144
Fax: (800) 274-6840
E-mail: powermatic@powermatic.com
Website: www.powermatic.com